

Trivella per roccia con lama portadenti Bullet blade rock auger

**Novità
New**

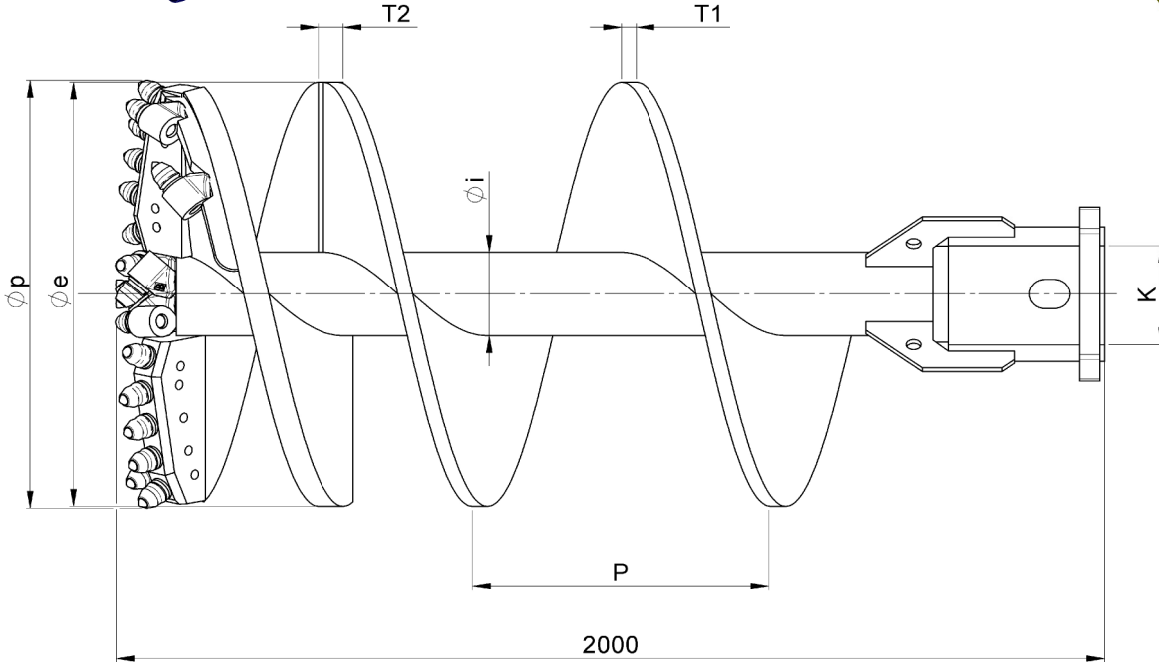
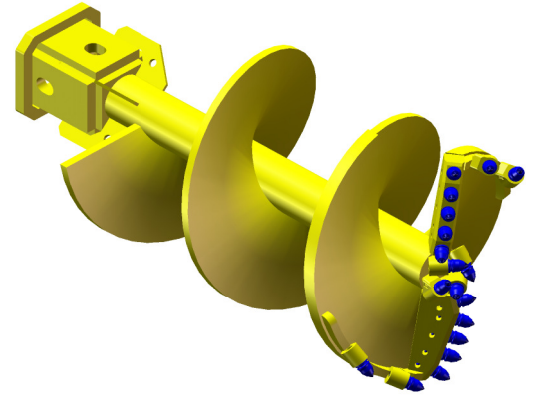
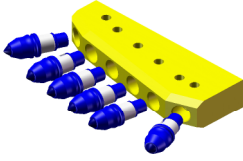

Diametro di perforazione	Diametro esterno elica	D. interno (D. tubo)	Passo	N° Picchi	Spessore spira	Spessore spira	Lato interno attacco quadro	Codice
Drilling Diameter	Auger external diameter	Internal Diam. (Pipe Diam.)	Pitch	Number of Bullets	Flight Thickness	Flight Thickness	Kelly Box dimension	Part Number
$\varnothing p$ (mm)	$\varnothing e$ (mm)	$\varnothing i$ (mm)	P (mm)	$\varnothing 30-38$ (BETEK)	T1 (mm)	T2 (mm)	K (mm)	
450	440	168	400	8	30	40	130	TL045-1-200-34
							200	TL045-2-200-34
500	490	168	500	10	30	40	130	TL050-1-200-34
							200	TL050-2-200-34
550	540	168	500	10	30	40	130	TL055-1-200-34
							200	TL055-2-200-34
600	590	177,8	500	12	30	40	130	TL060-1-200-34
							200	TL060-2-200-34
650	640	177,8	500	12	30	40	130	TL065-1-200-34
							200	TL065-2-200-34
700	690	177,8	500	14	30	40	130	TL070-1-200-34
							200	TL070-2-200-34
750	740	177,8	500	14	30	40	130	TL075-1-200-34
							200	TL075-2-200-34
800	790	177,8	600	14	30	40	130	TL080-1-200-34
							200	TL080-2-200-34
850	840	177,8	600	16	30	40	130	TL085-1-200-34
							200	TL085-2-200-34
900	890	177,8	600	16	30	40	130	TL090-1-200-34
							200	TL090-2-200-34
950	940	177,8	600	16	30	40	130	TL095-1-200-34
							200	TL095-2-200-34
1000	990	193	600	20	30	40	130	TL100-1-200-34
							200	TL100-2-200-34
1050	1040	193	600	20	30	40	130	TL105-1-200-34
							200	TL105-2-200-34
1100	1090	193	600	20	30	40	130	TL110-1-200-34
							200	TL110-2-200-34
1150	1140	193	600	22	30	40	130	TL115-1-200-34
							200	TL115-2-200-34
1200	1190	193	600	22	30	40	130	TL120-1-200-34
							200	TL120-2-200-34