

Aste elicoidali con attacco filettato conico Helicoidal Pipes with Conical Thread

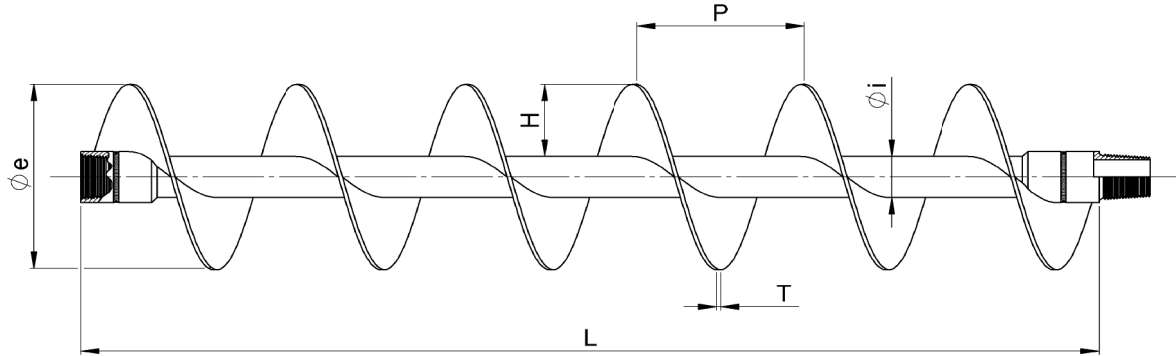
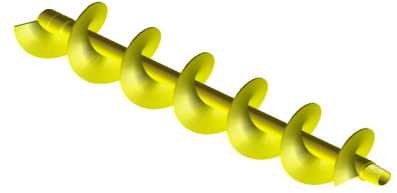

Diam. Esterno (Diam. perforaz.)	D. interno (D. tubo) x spessore tubo	Passo	Spessore Spira	Attacco	Altezza spira	Lungh.	Codice
External Diam. (Drilling Diam.)	Internal Diam. (Pipe Diam.) x pipe thickness	Pitch	Flight Thickness	Coupling	Flight height	Length	Part Number
Øe (mm)	Øi (mm)	P (mm)	T (mm)		H (mm)	L (mm)	
100	63,5 x 8	100	8	2"3/8 AR	18	1000	FA100-100-1-1
						1500	FA100-150-1-1
						2000	FA100-200-1-1
						3000	FA100-300-1-1
114	63,5 x 8	100	8	2"3/8 AR	25	1000	FA114-100-1-1
						1500	FA114-150-1-1
						2000	FA114-200-1-1
						3000	FA114-300-1-1
120	63,5 x 8	100	8	2"3/8 AR	28	1000	FA120-100-1-1
						1500	FA120-150-1-1
						2000	FA120-200-1-1
						3000	FA120-300-1-1
130	63,5 x 8	125	8	2"3/8 AR	33	1000	FA130-100-1-1
						1500	FA130-150-1-1
						2000	FA130-200-1-1
						3000	FA130-300-1-1
140	63,5 x 8	150	8	2"3/8 AR	38	1050	FA140-100-1-1
						1500	FA140-150-1-1
						2100	FA140-200-1-1
						3000	FA140-300-1-1
150	63,5 x 8	150	8	2"3/8 AR	43	1050	FA150-100-1-1
						1500	FA150-150-1-1
						2100	FA150-200-1-1
						3000	FA150-300-1-1
	76,1 x 8	150	8	2"3/8 AR	37	1050	FA150-100-1-2
						1500	FA150-150-1-2
						2100	FA150-200-1-2
						3000	FA150-300-1-2
	76,1 x 8	150	8	2"7/8 AR	37	1050	FA150-100-2-2
						1500	FA150-150-2-2
						2100	FA150-200-2-2
						3000	FA150-300-2-2

<i>Diam. Esterno (Diam. perforaz.)</i>	<i>D. interno (D. tubo) x spessore tubo</i>	<i>Passo</i>	<i>Spessore Spira</i>	<i>Attacco</i>	<i>Altezza spira</i>	<i>Lungh.</i>	<i>Codice</i>	
<i>External Diam. (Drilling Diam.)</i>	<i>Internal Diam. (Pipe Diam.) x pipe thickness</i>	<i>Pitch</i>	<i>Flight Thickness</i>	<i>Coupling</i>	<i>Flight height</i>	<i>Length</i>	<i>Part Number</i>	
<i>Øe (mm)</i>	<i>Øi (mm)</i>	<i>P (mm)</i>	<i>T (mm)</i>		<i>H (mm)</i>	<i>L (mm)</i>		
160	63,5 x 8	200	8	2"3/8 AR	48	1000	FA160-100-1-1	
						1500	FA160-150-1-1	
						2000	FA160-200-1-1	
						3000	FA160-300-1-1	
	76,1 x 8	200	8	2"3/8 AR	42	1000	FA160-100-1-2	
						1500	FA160-150-1-2	
						2000	FA160-200-1-2	
						3000	FA160-300-1-2	
	76,1 x 8	200	8	2"7/8 AR	42	1000	FA160-100-2-2	
						1500	FA160-150-2-2	
						2000	FA160-200-2-2	
						3000	FA160-300-2-2	
170	63,5 x 8	200	8	2"3/8 AR	53	1000	FA170-100-1-1	
						1500	FA170-150-1-1	
						2000	FA170-200-1-1	
						3000	FA170-300-1-1	
	76,1 x 8	200	8	2"3/8 AR	47	1000	FA170-100-1-2	
						1500	FA170-150-1-2	
						2000	FA170-200-1-2	
						3000	FA170-300-1-2	
	76,1 x 8	200	8	2"7/8 AR	47	1000	FA170-100-2-2	
						1500	FA170-150-2-2	
						2000	FA170-200-2-2	
						3000	FA170-300-2-2	
	88,9 x 8	200	8	2"7/8 AR	41	1000	FA170-100-2-3	
						1500	FA170-150-2-3	
						2000	FA170-200-2-3	
						3000	FA170-300-2-3	
	88,9 x 8	200	8	3"1/2 AR	41	1000	FA170-100-3-3	
						1500	FA170-150-3-3	
						2000	FA170-200-3-3	
						3000	FA170-300-3-3	
	180	63,5 x 8	200	8	2"3/8 AR	53	1000	FA180-100-1-1
							1500	FA180-150-1-1
							2000	FA180-200-1-1
							3000	FA180-300-1-1
76,1 x 8		200	8	2"3/8 AR	47	1000	FA180-100-1-2	
						1500	FA180-150-1-2	
						2000	FA180-200-1-2	
						3000	FA180-300-1-2	
76,1 x 8		200	8	2"7/8 AR	47	1000	FA180-100-2-2	
						1500	FA180-150-2-2	
						2000	FA180-200-2-2	
						3000	FA180-300-2-2	
88,9 x 8		200	8	2"7/8 AR	41	1000	FA180-100-2-3	
						1500	FA180-150-2-3	
						2000	FA180-200-2-3	
						3000	FA180-300-2-3	
88,9 x 8		200	8	3"1/2 AR	41	1000	FA180-100-3-3	
						1500	FA180-150-3-3	
						2000	FA180-200-3-3	
						3000	FA180-300-3-3	

<i>Diam. Esterno (Diam. perforaz.)</i>	<i>D. interno (D. tubo) x spessore tubo</i>	<i>Passo</i>	<i>Spessore Spira</i>	<i>Attacco</i>	<i>Altezza spira</i>	<i>Lungh.</i>	<i>Codice</i>
<i>External Diam. (Drilling Diam.)</i>	<i>Internal Diam. (Pipe Diam.) x pipe thickness</i>	<i>Pitch</i>	<i>Flight Thickness</i>	<i>Coupling</i>	<i>Flight height</i>	<i>Length</i>	<i>Part Number</i>
<i>Øe (mm)</i>	<i>Øi (mm)</i>	<i>P (mm)</i>	<i>T (mm)</i>		<i>H (mm)</i>	<i>L (mm)</i>	
200	63,5 x 8	200	8	2"3/8 AR	68	1000	FA200-100-1-1
						1500	FA200-150-1-1
						2000	FA200-200-1-1
						3000	FA200-300-1-1
	76,1 x 8	200	8	2"3/8 AR	62	1000	FA200-100-1-2
						1500	FA200-150-1-2
						2000	FA200-200-1-2
						3000	FA200-300-1-2
	76,1 x 8	200	8	2"7/8 AR	62	1000	FA200-100-2-2
						1500	FA200-150-2-2
						2000	FA200-200-2-2
						3000	FA200-300-2-2
	88,9 x 8	200	8	2"7/8 AR	56	1000	FA200-100-2-3
						1500	FA200-150-2-3
						2000	FA200-200-2-3
						3000	FA200-300-2-3
88,9 x 8	200	8	3"1/2 AR	56	1000	FA200-100-3-3	
					1500	FA200-150-3-3	
					2000	FA200-200-3-3	
					3000	FA200-300-3-3	
220	76,1 x 8	200	8	2"3/8 AR	72	1000	FA220-100-1-2
						1500	FA220-150-1-2
						2000	FA220-200-1-2
						3000	FA220-300-1-2
	76,1 x 8	200	8	2"7/8 AR	72	1000	FA220-100-2-2
						1500	FA220-150-2-2
						2000	FA220-200-2-2
						3000	FA220-300-2-2
	88,9 x 8	200	8	2"7/8 AR	66	1000	FA220-100-2-3
						1500	FA220-150-2-3
						2000	FA220-200-2-3
						3000	FA220-300-2-3
	88,9 x 8	200	8	3"1/2 AR	66	1000	FA220-100-3-3
						1500	FA220-150-3-3
						2000	FA220-200-3-3
						3000	FA220-300-3-3
250	76,1 x 8	250	8	2"3/8 AR	87	1000	FA250-100-1-2
						1500	FA250-150-1-2
						2000	FA250-200-1-2
						3000	FA250-300-1-2
	76,1 x 8	250	8	2"7/8 AR	87	1000	FA250-100-2-2
						1500	FA250-150-2-2
						2000	FA250-200-2-2
						3000	FA250-300-2-2
	88,9 x 8	250	8	2"7/8 AR	81	1000	FA250-100-2-3
						1500	FA250-150-2-3
						2000	FA250-200-2-3
						3000	FA250-300-2-3

Carandina s.r.l. migliora costantemente i propri prodotti riservandosi il diritto di apportare qualsiasi modifica senza preavviso.-Carandina s.r.l. continually improve its products reserving the right to modify data without warning.

<i>Diam. Esterno (Diam. perforaz.)</i>	<i>D. interno (D. tubo) x spessore tubo</i>	<i>Passo</i>	<i>Spessore Spira</i>	<i>Attacco</i>	<i>Altezza spira</i>	<i>Lungh.</i>	<i>Codice</i>
<i>External Diam. (Drilling Diam.)</i>	<i>Internal Diam. (Pipe Diam.) x pipe thickness</i>	<i>Pitch</i>	<i>Flight Thickness</i>	<i>Coupling</i>	<i>Flight height</i>	<i>Length</i>	<i>Part Number</i>
<i>Øe (mm)</i>	<i>Øi (mm)</i>	<i>P (mm)</i>	<i>T (mm)</i>		<i>H (mm)</i>	<i>L (mm)</i>	
250	88,9 x 8	250	8	3"1/2 AR	81	1000	FA250-100-3-3
						1500	FA250-150-3-3
						2000	FA250-200-3-3
						3000	FA250-300-3-3
	114,3 x 8	250	8	3"1/2 AR	68	1000	FA250-100-3-4
						1500	FA250-150-3-4
						2000	FA250-200-3-4
						3000	FA250-300-3-4
	114,3 x 8	250	8	4"1/2 AR	68	1000	FA250-100-4-4
						1500	FA250-150-4-4
						2000	FA250-200-4-4
						3000	FA250-300-4-4
300	76,1 x 8	250	8	2"3/8 AR	112	1000	FA300-100-1-2
						1500	FA300-150-1-2
						2000	FA300-200-1-2
						3000	FA300-300-1-2
	76,1 x 8	250	8	2"7/8 AR	112	1000	FA300-100-2-2
						1500	FA300-150-2-2
						2000	FA300-200-2-2
						3000	FA300-300-2-2
	88,9 x 8	250	8	2"7/8 AR	106	1000	FA300-100-2-3
						1500	FA300-150-2-3
						2000	FA300-200-2-3
						3000	FA300-300-2-3
	88,9 x 8	250	8	3"1/2 AR	106	1000	FA300-100-3-3
						1500	FA300-150-3-3
						2000	FA300-200-3-3
						3000	FA300-300-3-3
	114,3 x 8	250	8	3"1/2 AR	93	1000	FA300-100-3-4
						1500	FA300-150-3-4
						2000	FA300-200-3-4
						3000	FA300-300-3-4
	114,3 x 8	250	8	4"1/2 AR	93	1000	FA300-100-4-4
						1500	FA300-150-4-4
						2000	FA300-200-4-4
						3000	FA300-300-4-4
350	88,9 x 8	0	8	2"7/8 AR	131	1000	FA350-100-2-3
						1500	FA350-150-2-3
						2000	FA350-200-2-3
						3000	FA350-300-2-3
	88,9 x 8	0	8	3"1/2 AR	131	1000	FA350-100-3-3
						1500	FA350-150-3-3
						2000	FA350-200-3-3
						3000	FA350-300-3-3
	114,3 x 8	0	8	3"1/2 AR	118	1000	FA350-100-3-4
						1500	FA350-150-3-4
						2000	FA350-200-3-4
						3000	FA350-300-3-4
	114,3 x 8	0	8	4"1/2 AR	118	1000	FA350-100-4-4
						1500	FA350-150-4-4
						2000	FA350-200-4-4
						3000	FA350-300-4-4

<i>Diam. Esterno (Diam. perforaz.)</i>	<i>D. interno (D. tubo) x spessore tubo</i>	<i>Passo</i>	<i>Spessore Spira</i>	<i>Attacco</i>	<i>Altezza spira</i>	<i>Lungh.</i>	<i>Codice</i>
<i>External Diam. (Drilling Diam.)</i>	<i>Internal Diam. (Pipe Diam.) x pipe thickness</i>	<i>Pitch</i>	<i>Flight Thickness</i>	<i>Coupling</i>	<i>Flight height</i>	<i>Length</i>	<i>Part Number</i>
<i>Øe (mm)</i>	<i>Øi (mm)</i>	<i>P (mm)</i>	<i>T (mm)</i>		<i>H (mm)</i>	<i>L (mm)</i>	
400	114,3 x 8	330	8	3"1/2 AR	143	990	FA400-100-3-4
						1510	FA400-150-3-4
						1980	FA400-200-3-4
						3020	FA400-300-3-4
	127 x 8	330	8	3"1/2 AR	137	1000	FA400-100-3-5
						1500	FA400-150-3-5
						2000	FA400-200-3-5
						3000	FA400-300-3-5
	114,3 x 8	330	8	4"1/2 AR	143	990	FA400-100-4-4
						1510	FA400-150-4-4
						1980	FA400-200-4-4
						3020	FA400-300-4-4
	127 x 8	330	8	4"1/2 AR	137	1000	FA400-100-4-5
						1500	FA400-150-4-5
						2000	FA400-200-4-5
						3000	FA400-300-4-5

Carandina s.r.l. migliora costantemente i propri prodotti riservandosi il diritto di apportare qualsiasi modifica senza preavviso.-Carandina s.r.l. continually improve its products reserving the right to modify data without warning.